

DETECTABLE WARNING GENERAL NOTES:

- FOR ADAAG COMPLIANCE, DETECTABLE WARNING SURFACES MUST BE PROVIDED ON ALL PEDESTRIAN CURB RAMPS, MEDIANS AND PEDESTRIAN REFUGE ISLANDS, RAILROAD CROSSINGS AND AT GRADE SIDEWALK INTERSECTIONS WITH ROADWAYS, DRIVEWAYS WITH STOP OR YIELD SIGNS, SIGNALS, OR BUS STOPS.
- CURB RAMPS MUST CONTAIN A DETECTABLE WARNING SURFACE THAT CONSISTS OF RAISED TRUNCATED DOMES COMPLYING WITH ADA GUIDELINES. THE SURFACE MUST CONTRAST VISUALLY WITH ADJOINING SURFACES, INCLUDING SIDE FLARES, IN ACCORDANCE WITH APPLICABLE SECTIONS OF THE STANDARD SPECIFICATIONS. COLOR FOR DETECTABLE WARNING SURFACE SHALL BE YELLOW UNLESS OTHERWISE SPECIFIED IN THE PLANS OR BY THE PROJECT ENGINEER.
- DETECTABLE WARNING SURFACES MUST BE SLIP RESISTANT AND NOT ALLOW WATER TO ACCUMULATE.
- ALIGN TRUNCATED DOMES IN THE DIRECTION OF PEDESTRIAN TRAVEL WHEN ENTERING THE STREET.
- DETECTABLE WARNING SURFACES SHALL BE A MINIMUM OF 24" IN DEPTH IN THE DIRECTION OF PEDESTRIAN TRAVEL AND EXTEND THE FULL WIDTH OF THE THROAT OF THE CURB RAMP OR LANDING WHERE THE PEDESTRIAN ACCESS ROUTE ENTERS THE STREET.
- THE RAMP GRADE BREAK SHALL BE LOCATED ALONG THE FRONT EDGE OF THE DETECTABLE WARNING SURFACE.
- DETECTABLE WARNING SURFACES (TRUNCATED DOMES) MAY BE STAMPED, CONSTRUCTED OF BRICK PAVERS OR INLAID PREFABRICATED MATS ATTACHED BY EPOXY ADHESIVE AND MECHANICAL ATTACHMENT.
- FOR STAMPED APPLICATIONS, THE DETECTABLE WARNING SURFACE WILL BE STAMPED AND STAINED IN ACCORDANCE WITH MANUFACTURER'S RECOMMENDATIONS. HOWEVER, THE FOLLOWING CRITERIA SHALL BE USED FOR THE CONCRETE MIX DESIGN IN THE OVERALL CONSTRUCTION OF HANDICAP RAMPS:
  - AVERAGE COMPRESSIVE STRENGTH: 6000 PSI
  - AGGREGATE GRADATION: TYPE B PAVEMENT GRADATION
  - MINIMUM CEMENT CONTENT: 600 POUNDS PER CUBIC YARD
  - MAXIMUM WATER/CEMENT RATIO: 0.40
  - TOTAL AIR CONTENT: 5% (+/-2%)
  - MAXIMUM SLUMP: 6 INCHES
  - CURING: THE EXPOSED PLAIN CONCRETE (NON-COLOR STAINED CONCRETE) SURFACE SHOULD HAVE A WHITE PIGMENT CURING COMPOUND APPLIED IN SUCH A MANNER THAT THE SURFACE AND ANY EXPOSED SIDES ARE EVENLY AND UNIFORMLY COVERED TO RESEMBLE A WHITE SHEET OF PAPER. IN NO CASE SHOULD THE APPLICATION OF CURING COMPOUND BE LESS THAN 1 GALLON PER 100 SQUARE FEET.
- ANY RETROFIT APPLICATION MUST HAVE BEVELED EDGES ON THE SIDES WITH APPROACH PEDESTRIAN TRAFFIC.

VIEWING ONLY

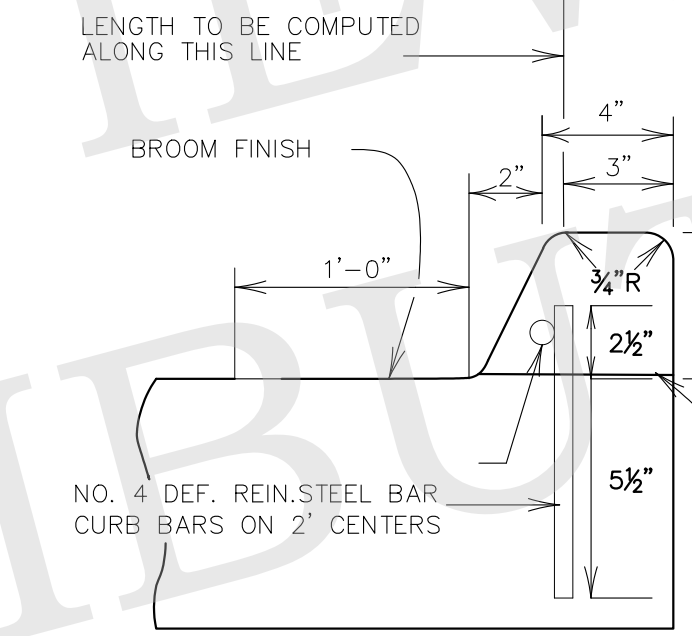

(BARRIER TYPE 4")

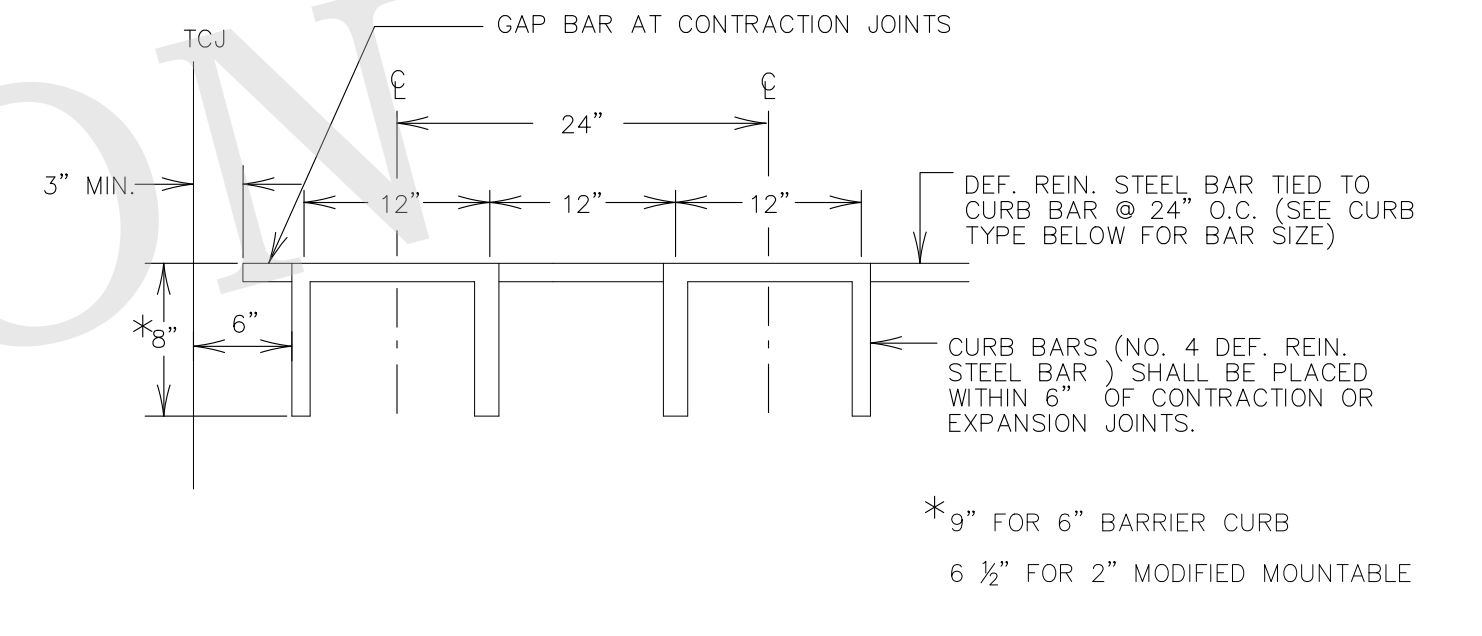

BAR DETAIL- BARRIER (INTEGRAL)

SHOWING DIMENSIONS AND SPACING OF NO. 4 CURB BARS AND LONGITUDINAL BARS FOR CONC. CURB

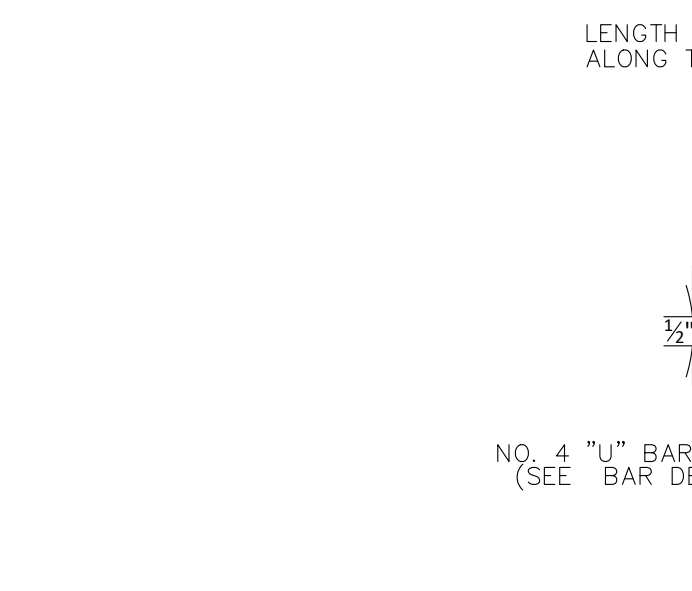

(MODIFIED MOUNTABLE)

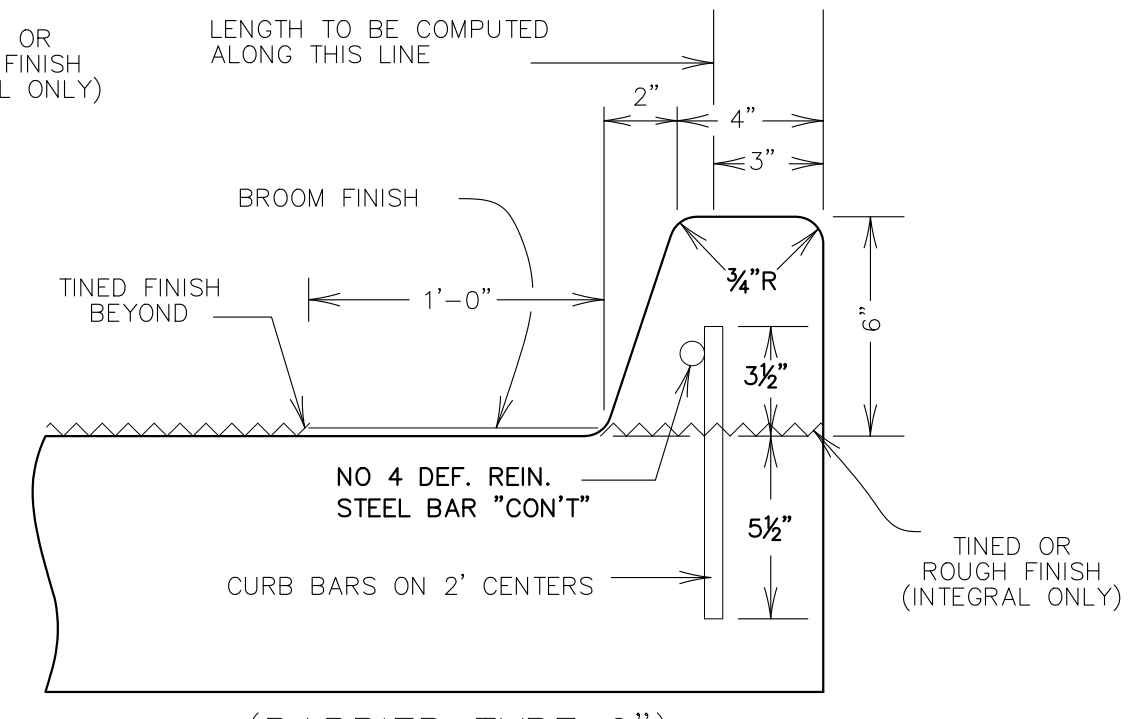

(BARRIER TYPE 6")

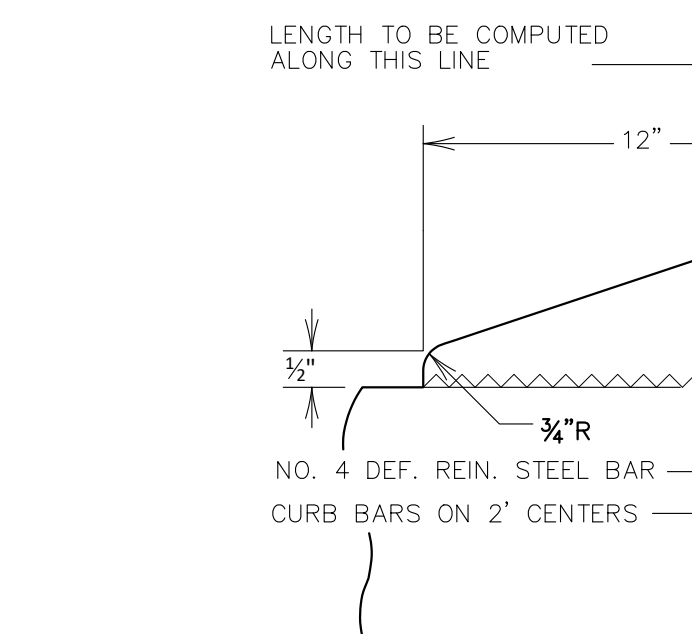

(MOUNTABLE TYPE)

CONCRETE CURB

STEEL REINFORCEMENT NOT NECESSARY IF CONSTRUCTED MONOLITHICALLY WITH THE PAVEMENT

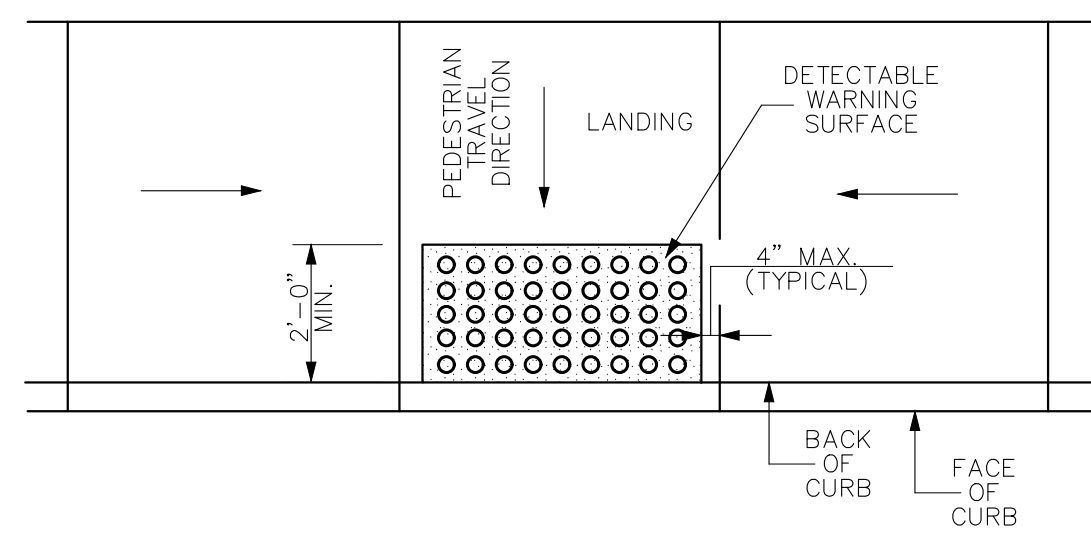

TYPICAL PLACEMENT OF  
DETECTABLE WARNING SURFACE  
ON PARALLEL CURB RAMP

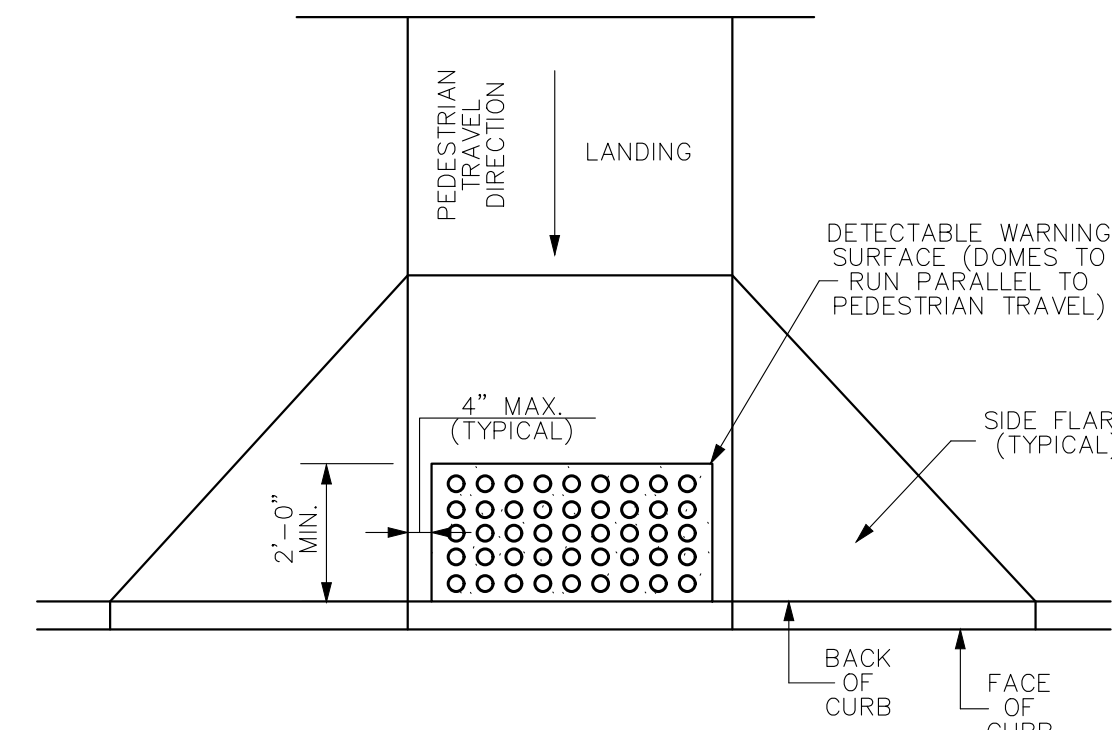

TYPICAL PLACEMENT OF  
DETECTABLE WARNING SURFACE  
ON PERPENDICULAR CURB RAMP

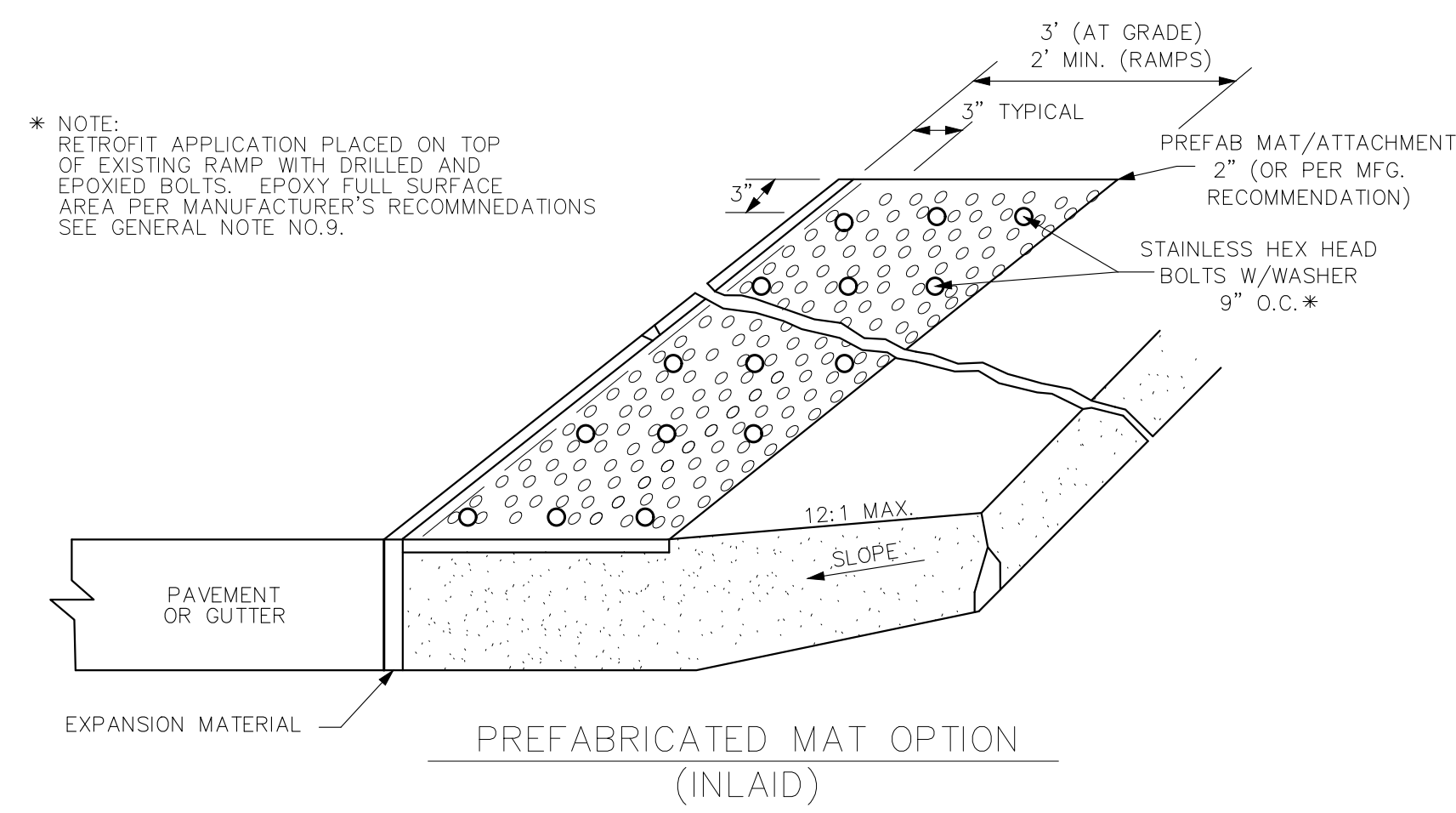

PREFABRICATED MAT OPTION  
(INLAID)

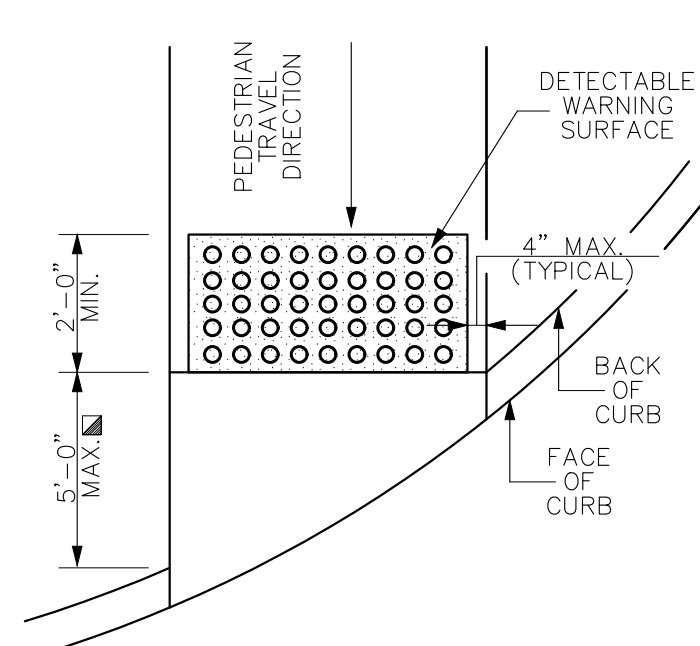

TYPICAL PLACEMENT OF  
DETECTABLE WARNING SURFACE  
WITH A CURB IN A RADIUS

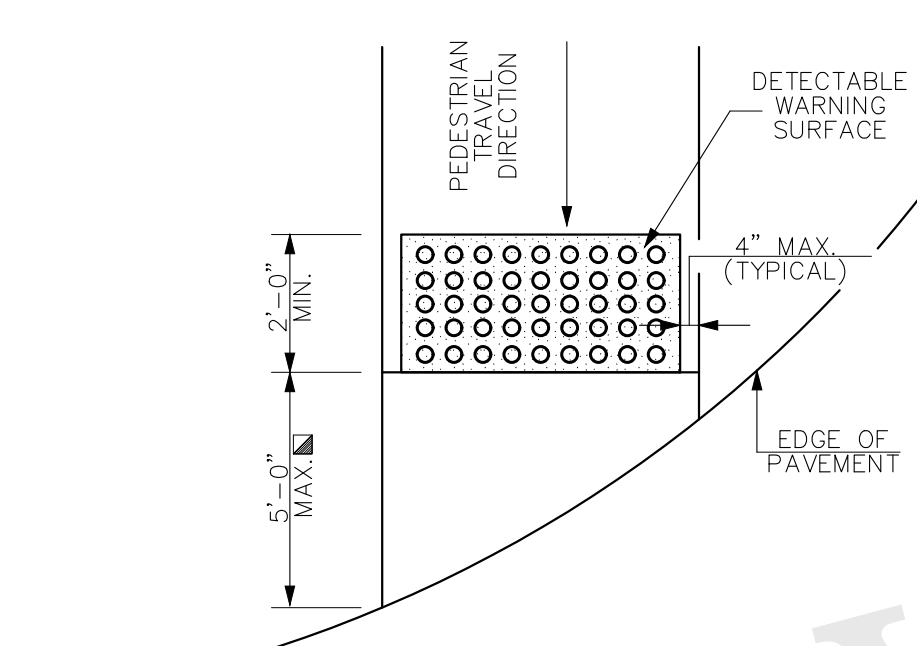

TYPICAL PLACEMENT OF  
DETECTABLE WARNING SURFACE  
WITHOUT A CURB IN A RADIUS

SHOULD GEOMETRIC CONSTRAINTS CAUSE THE DIMENSION TO EXCEED 5 FEET, THE DETECTABLE WARNING SURFACE SHALL BE SUCH THAT THE CORNERS ARE AT THE BACK OF CURB OR 6 INCH MAXIMUM FROM THE EDGE OF PAVEMENT.

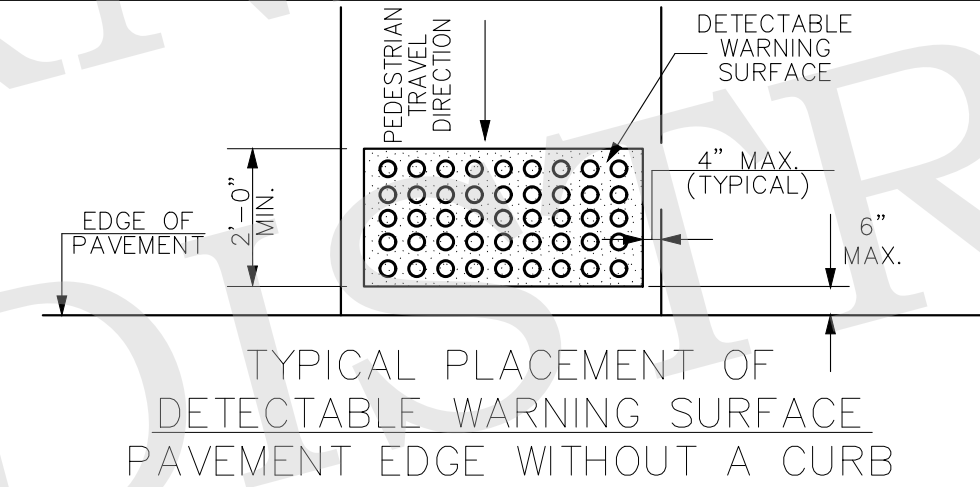

TYPICAL PLACEMENT OF  
DETECTABLE WARNING SURFACE  
PAVEMENT EDGE WITHOUT A CURB

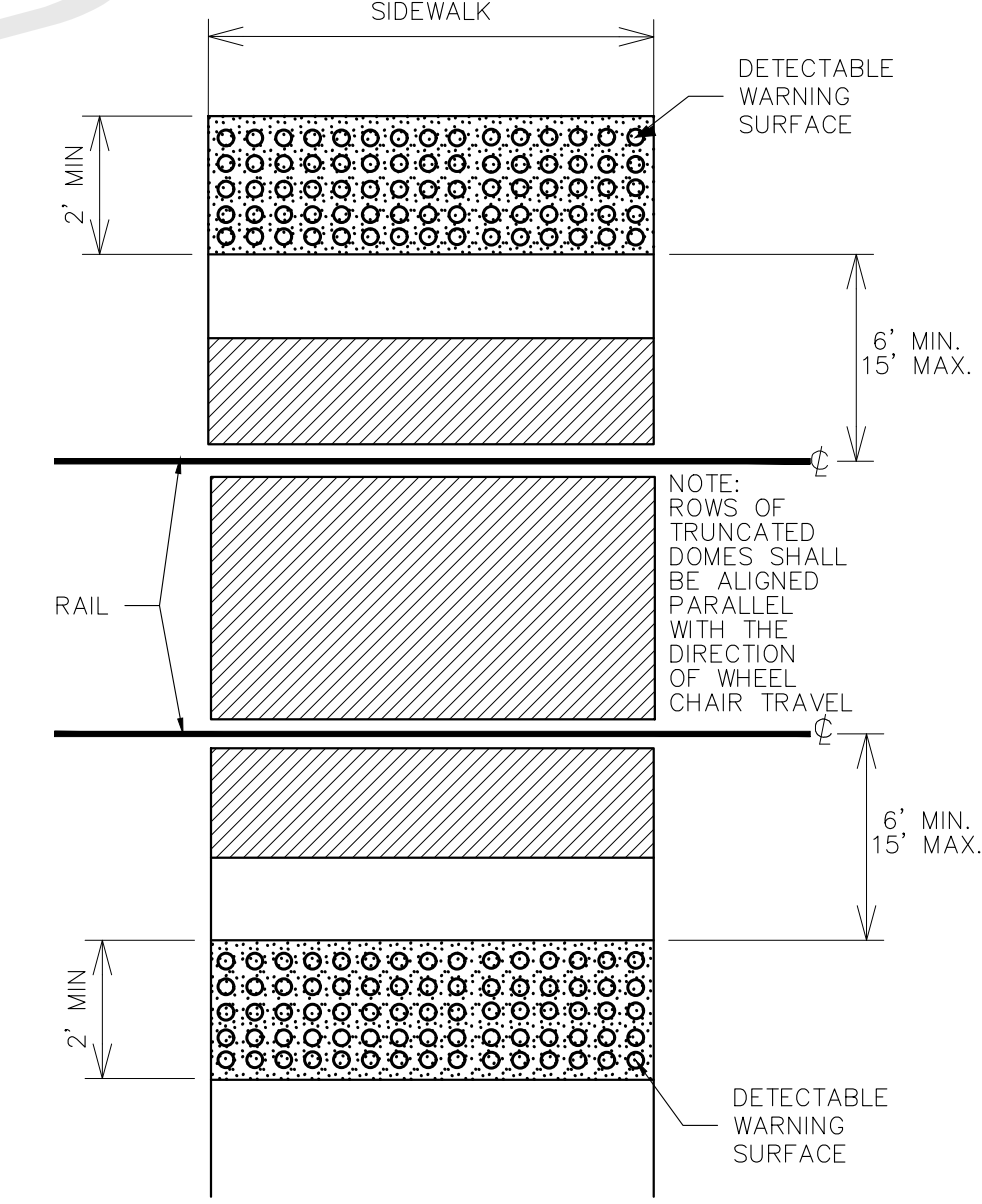

PREFABRICATED MAT OPTION  
(INLAID)

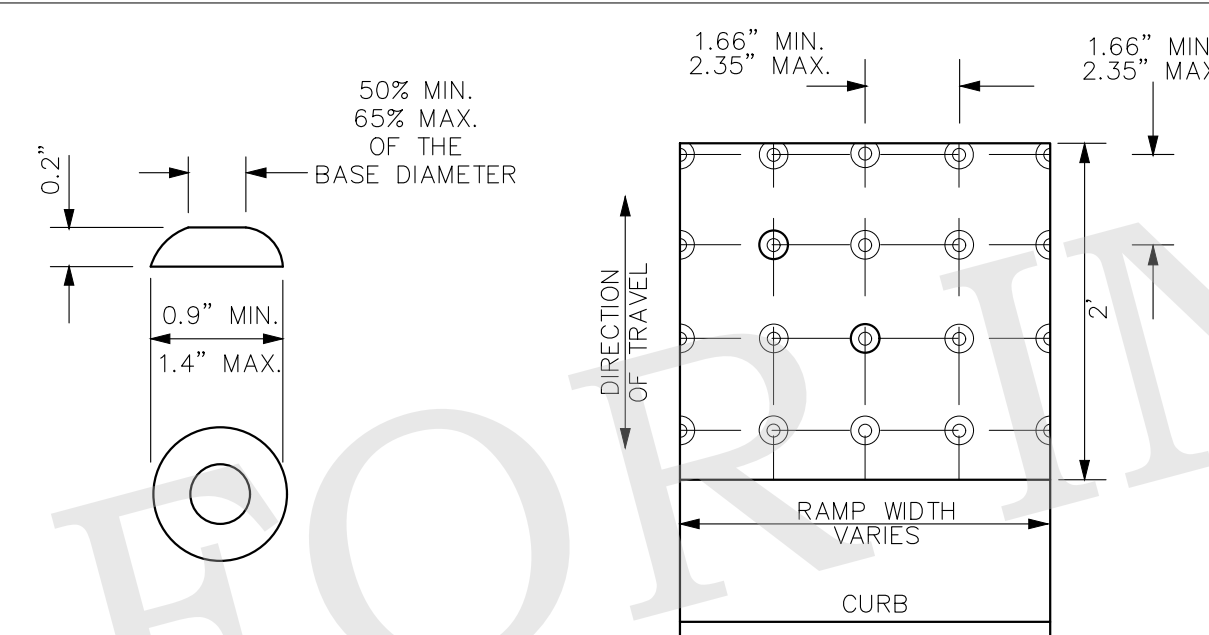

TRUNCATED DOME  
DETAIL

TRUNCATED DOME  
PATTERN DETAIL

TRUNCATED DOME  
PAVER DETAIL

\* NOTE: PLACE TRUNCATED DOMES DETECTABLE WARNING TEXTURE IN THE LOWER 2' OF THROAT OF RAMP ONLY AND A 3' WIDE PATTERN AT "AT-GRADE" SIDEWALK INTERSECTIONS WITH ROADWAYS. DOMES SHALL BE ARRANGED IN A SQUARE IN-LINE PATTERN ONLY AS SHOWN.

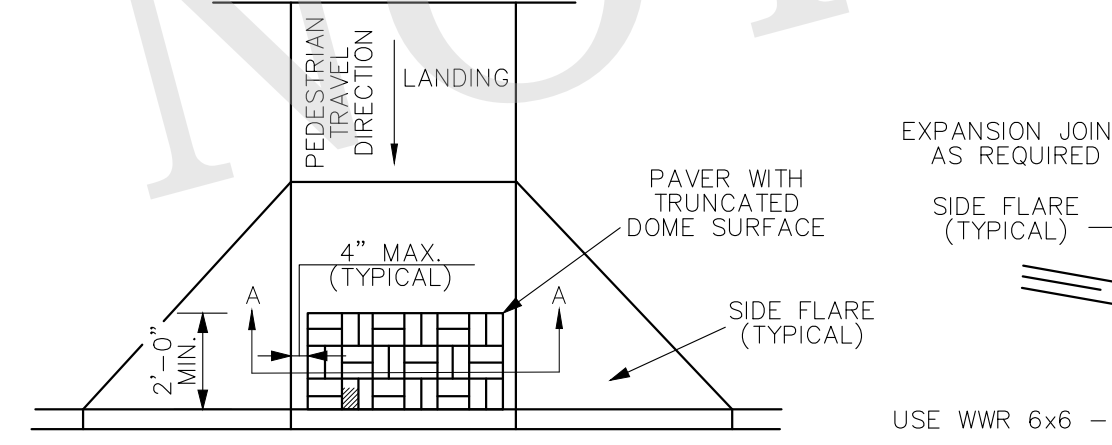

TRUNCATED DOME  
PAVER LAYOUT

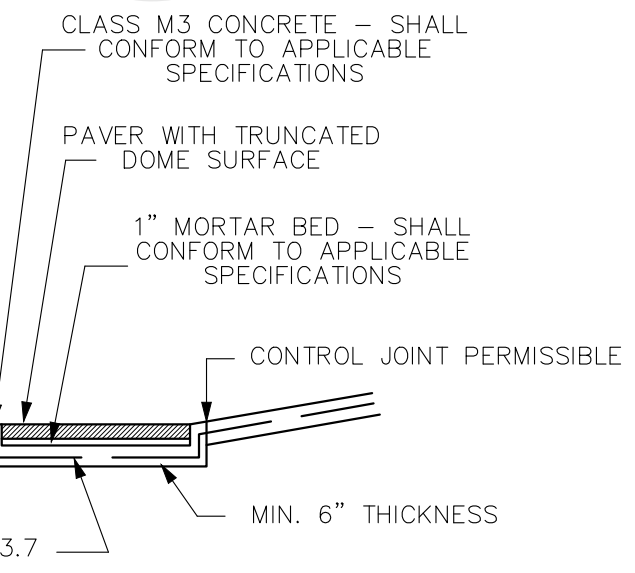

SECTION A-A

DETECTABLE WARNINGS  
(PAVER OPTION)

GENERAL NOTES FOR PAVER OPTION:

- PAVER UNITS SHALL MEET ALL REQUIREMENTS OF THE APPLICABLE ASTM STANDARDS. LAYOUT PATTERN SHALL BE APPROPRIATE FOR SIZE PAVER USED. 4"x8" PAVERS SHALL BE LAID OUT IN A 2x2 BASKET WEAVE PATTERN. 12"x12" PAVERS SHALL BE LAID OUT IN A BLOCK PATTERN.
- PAVER UNITS SHALL HAVE A TRUNCATED DOME TOP SURFACE FOR DETECTABLE WARNING TO PEDESTRIANS.
- PAVER UNITS SHALL BE SAW CUT ONLY AND ANY CUT UNIT SHALL NOT BE LESS THAN 25 PERCENT OF A FULL UNIT.
- TRUNCATED DOME SYSTEM SHALL BE PAID FOR IN ACCORDANCE WITH THE APPLICABLE SECTIONS OF THE STANDARD SPECIFICATIONS.