

DETAILS "A-D"

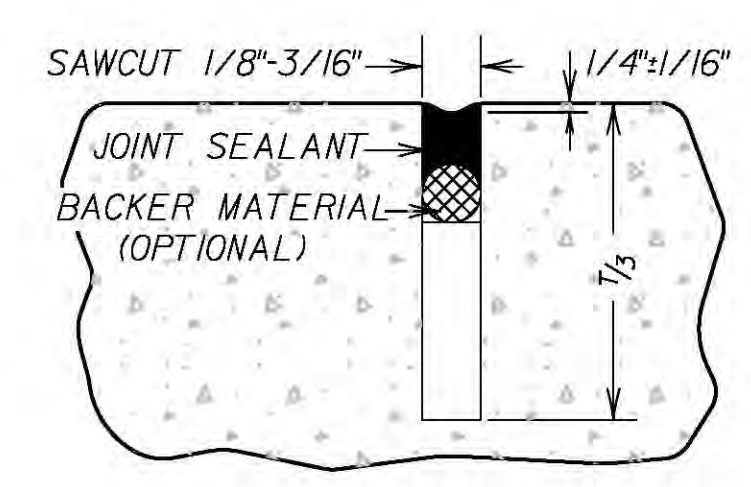

DETAIL "A"

ALLOWED FOR ALL DESIGN SPEEDS. USE THIS DETAIL IN CONJUNCTION WITH TYPE TCJ AND CJ JOINTS (SECTION B-B); TYPE LJ JOINT (SECTION D-D) AND NOTE (8 & 9) ON SHEET NO. 1.

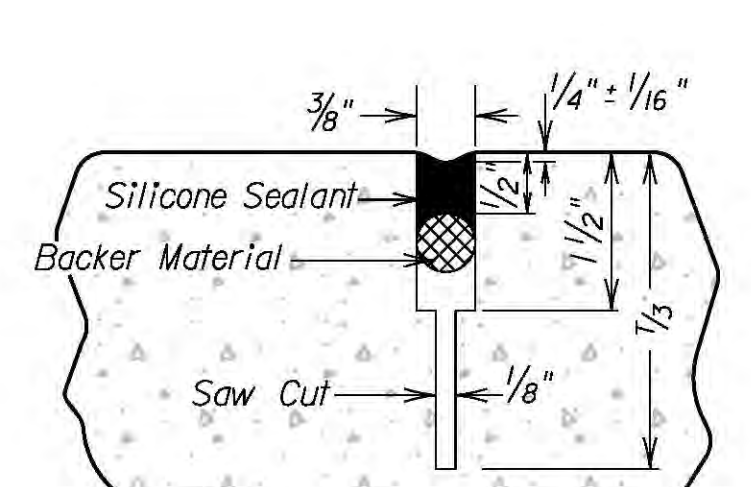

DETAIL "B" (10)

ALLOWED FOR ALL DESIGN SPEEDS.

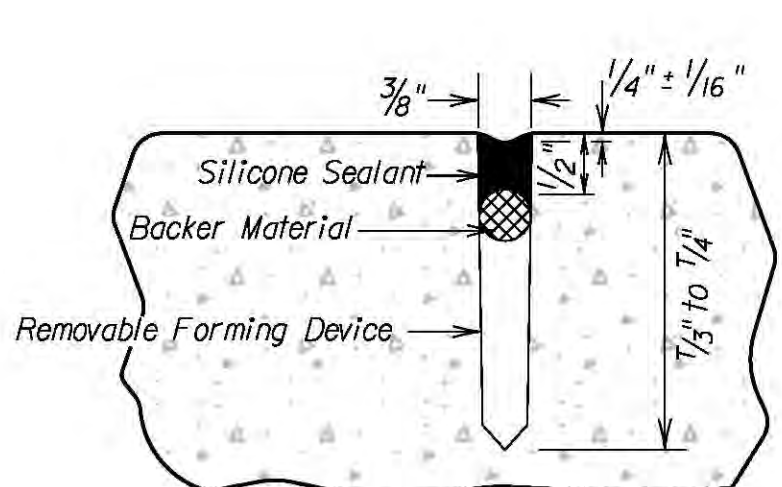

DETAIL "C"

NOT ALLOWED FOR DESIGN SPEEDS GREATER THAN 45 MPH.

REMOVE CAP AFTER CONCRETE HAS HARDENED SUFFICIENTLY TO PERMIT REMOVAL WITHOUT DAMAGE TO THE JOINT.

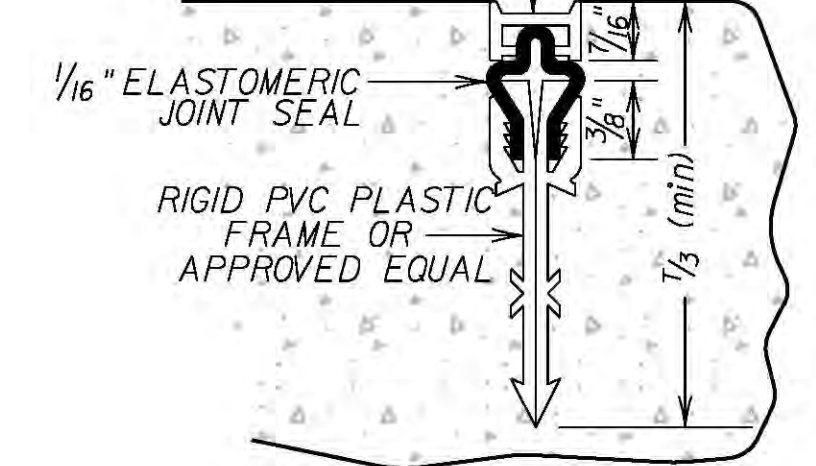

DETAIL "D"

NOT ALLOWED FOR DESIGN SPEEDS GREATER THAN 45 MPH OR WHEN THE PAVEMENT IS PLACED ON PERMEABLE BASES.

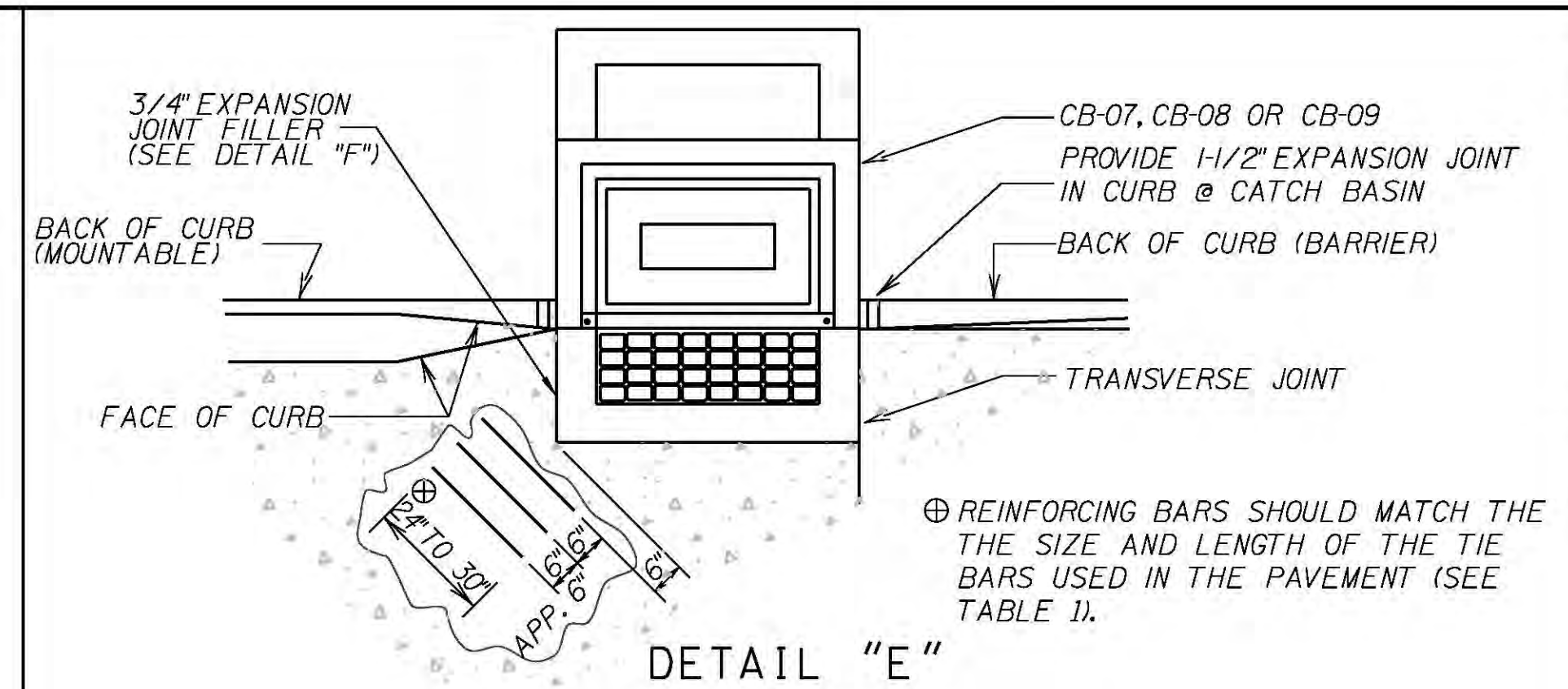

DETAIL "E"

TRANSVERSE JOINT AT CATCH BASIN

⊕ REINFORCING BARS SHOULD MATCH THE SIZE AND LENGTH OF THE TIE BARS USED IN THE PAVEMENT (SEE TABLE 1).

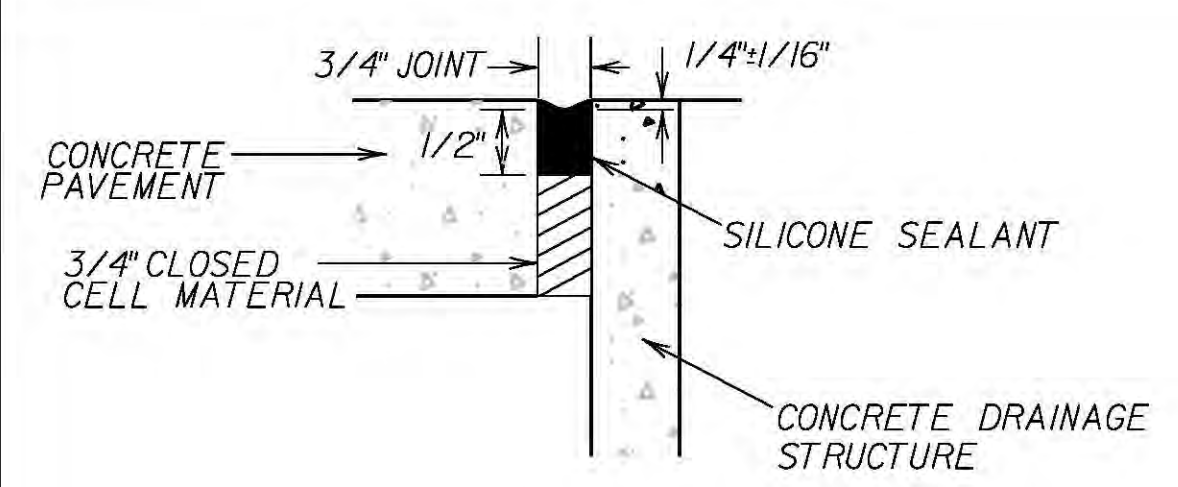

DETAIL "F"

AFTER CATCH BASIN TOP IS POURED, THE TOP OF THE 3/4" JOINT FILLER IS TO BE REMOVED TO THE DEPTH SHOWN PRIOR TO SEALING. THE CURB FACES ADJACENT TO THE BASIN SHALL ALSO BE SEALED. JOINT FACES SHALL BE CLEANED IN ACCORDANCE WITH SECTION 601.

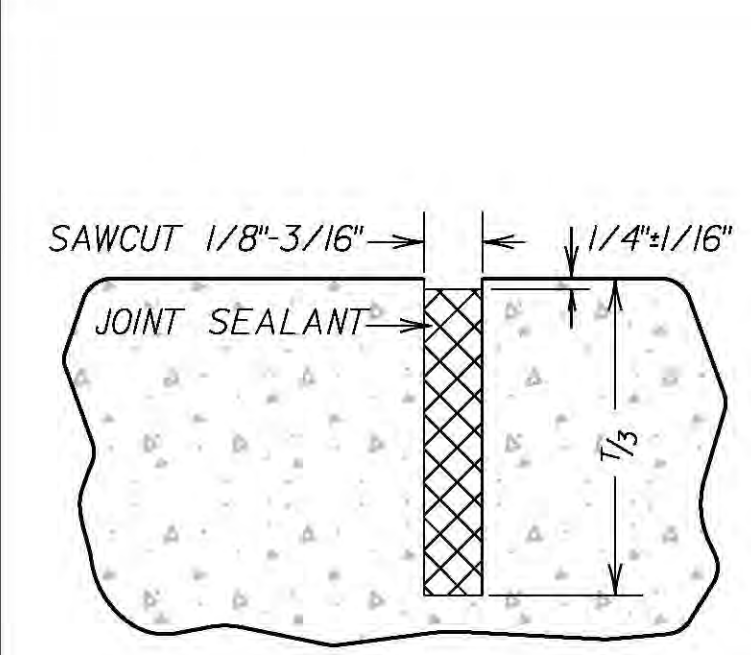

DETAIL "G"

ALLOWED FOR ALL DESIGN SPEEDS.

DETAILS "G-I"

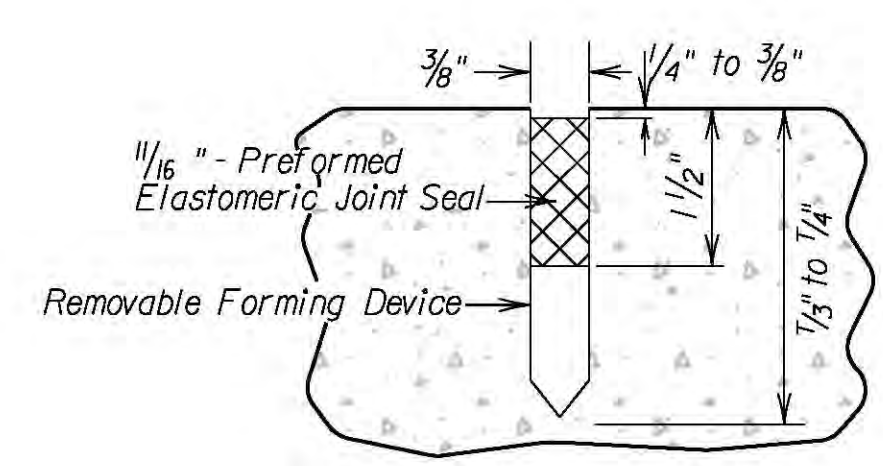

DETAIL "H"

NOT ALLOWED FOR DESIGN SPEEDS GREATER THAN 45 MPH.

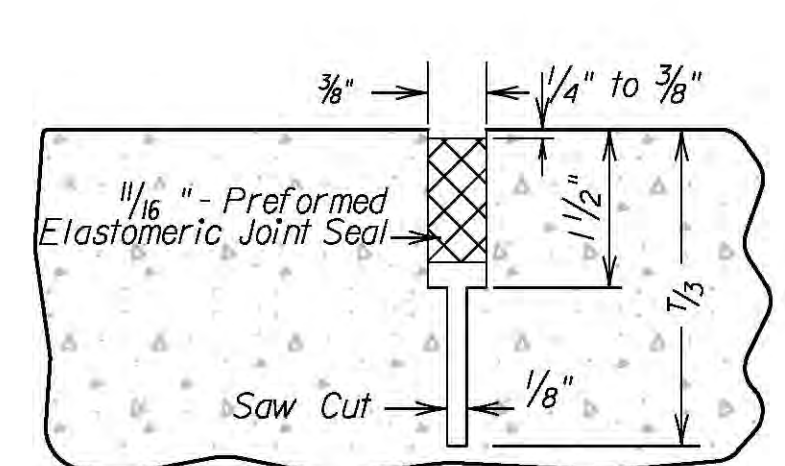

DETAIL "I" (10)

ALLOWED FOR ALL DESIGN SPEEDS.

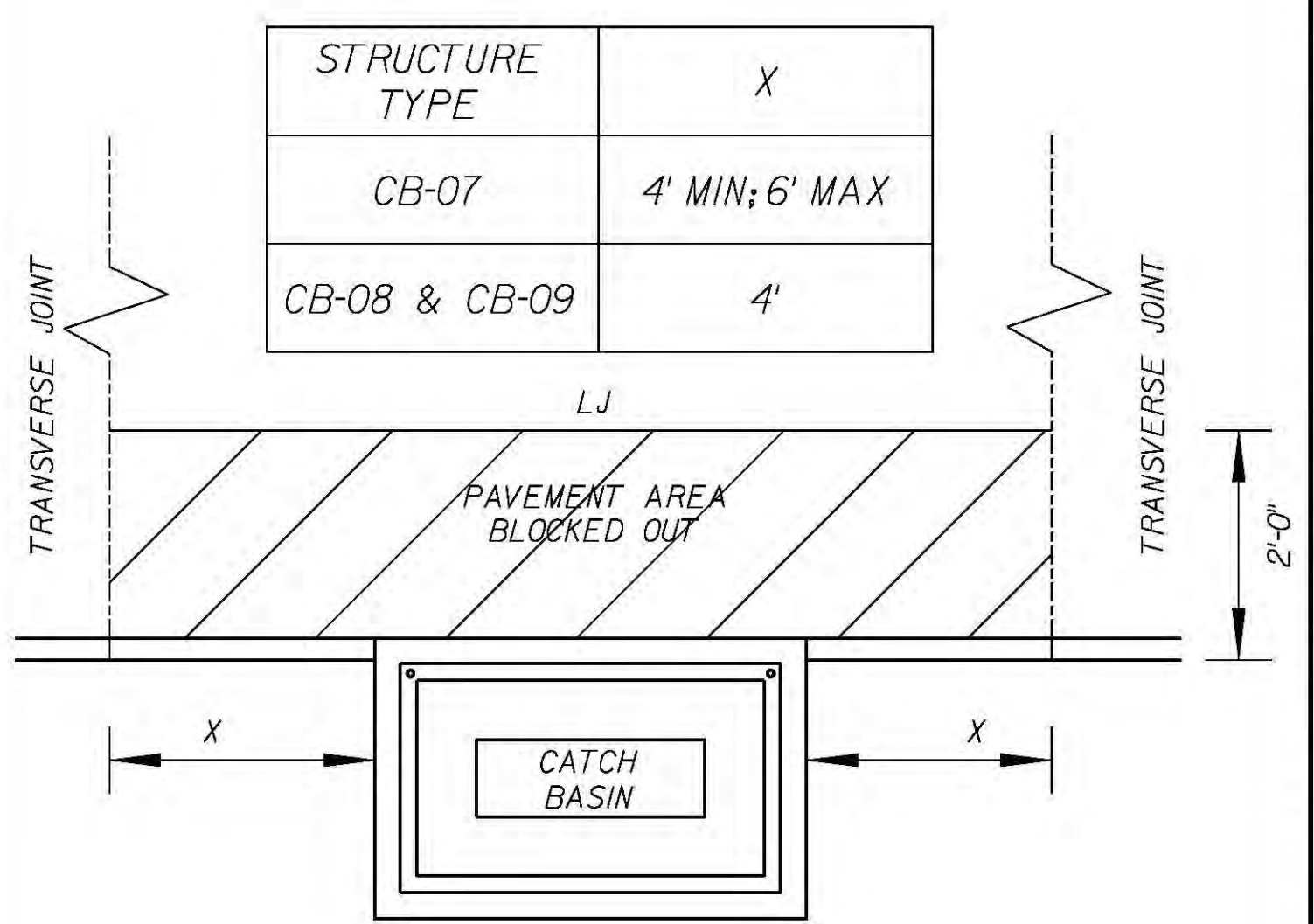

DETAIL "J"

PLAN VIEW OF PAVEMENT BLOCK OUT AT CATCH BASIN

STRUCTURE TYPE	X
CB-07	4' MIN; 6' MAX
CB-08 & CB-09	4'

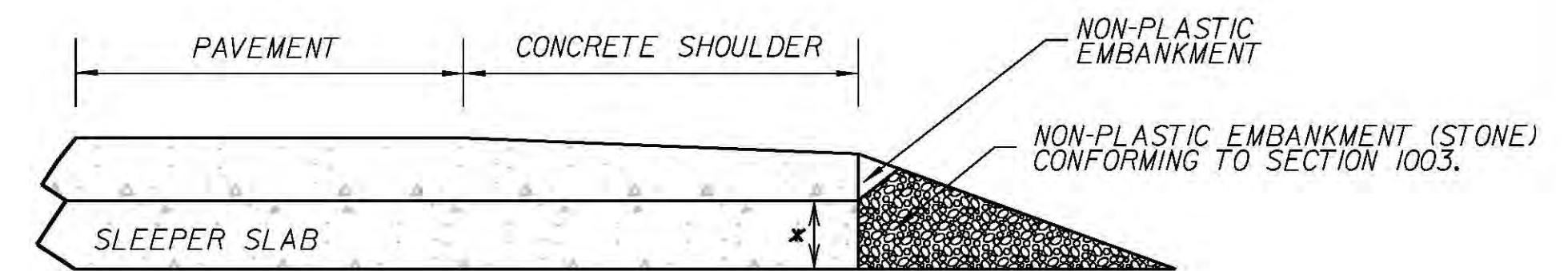

SECTION K-K
SHOULDER UNDERDRAIN
(WITH CONCRETE SHOULDER)

* SEE TYPICAL SECTION FOR DEPTH (12" MIN.)

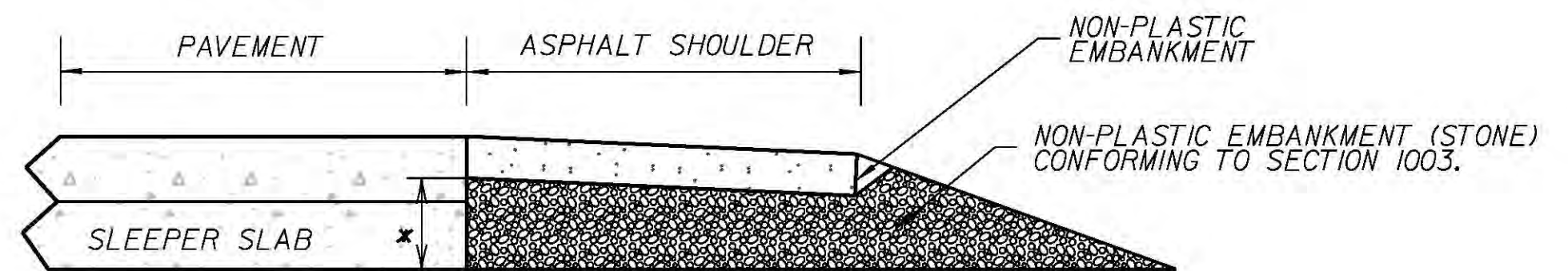

SECTION L-L
SHOULDER UNDERDRAIN
(WITH ASPHALT SHOULDER)

* SEE TYPICAL SECTION FOR DEPTH (12" MIN.)

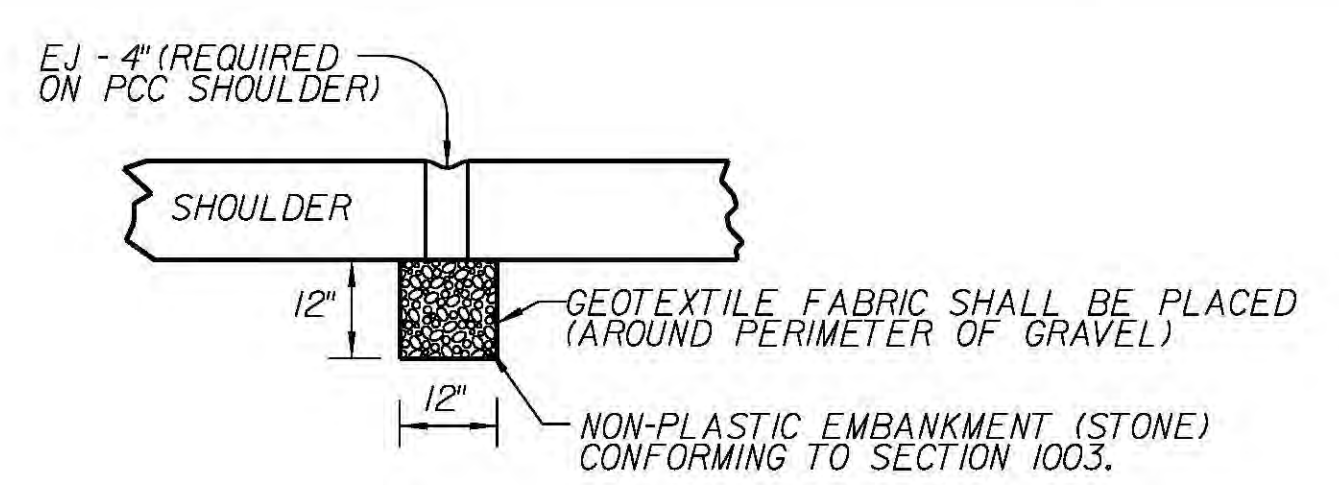

SECTION M-M
(SLEEPER SLAB NOT SHOWN)

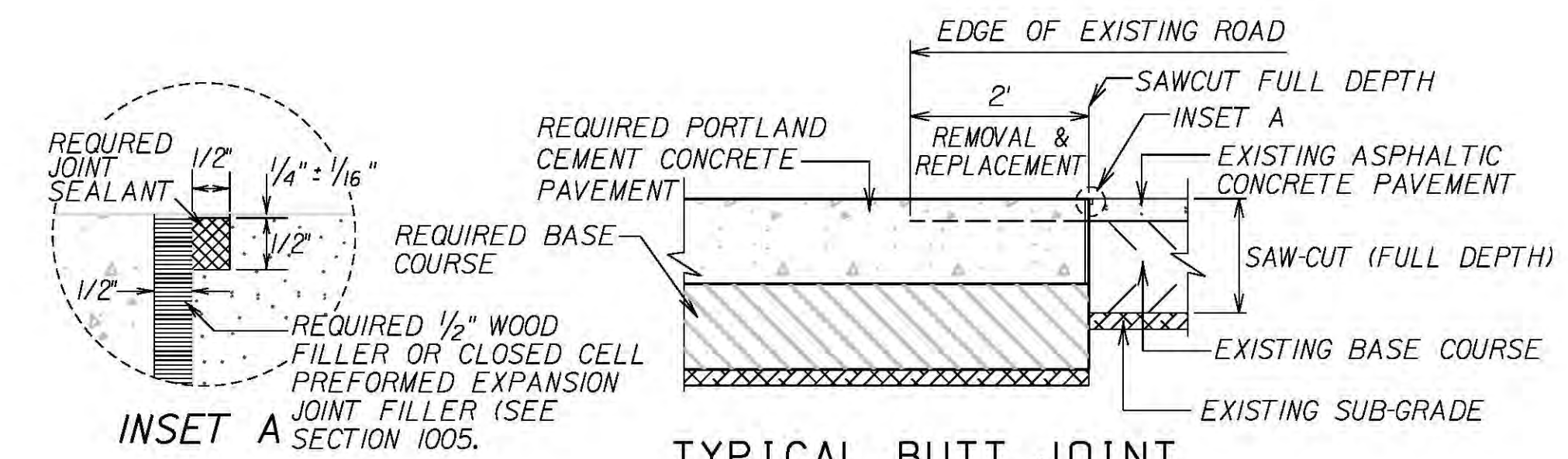

TYPICAL BUTT JOINT

N.T.S.

NOT TO SCALE